



series 260 for AIR - WATER
closed and swivelling



Art. 89010

PATENTED



Enclosed automatic hose-reel for air and water with adjustable bayonet coupling bracket, indispensable for use with air-operated tools or delivery of water in all industries, workshops, service stations, garage, etc.

The hose-reel allows the desired length of hose to be extracted quickly and easily, for better work and functionality.

Art. 89010 **Hose-reel series 260 for air or water**
Complete with bayonet coupling bracket (art.89001)
and outlet swivel joint M 1/4" G

📦 N° 1 packing m³ 0,019 📦 kg 6,5

Art. 89001 **Bayonet coupling wall bracket**
already standard with hose-reels
series 260



Use with water at distributor

Article	89010
Relative capacity	280 l/min
Hose	air-water 11 m
Connection hose	1,5 m
Diameter hose	ø8 x ø12 mm
Inlet and outlet connection	M 1/4" G
Max. working pressure	20 bar
Working temperature	-20° +60°C

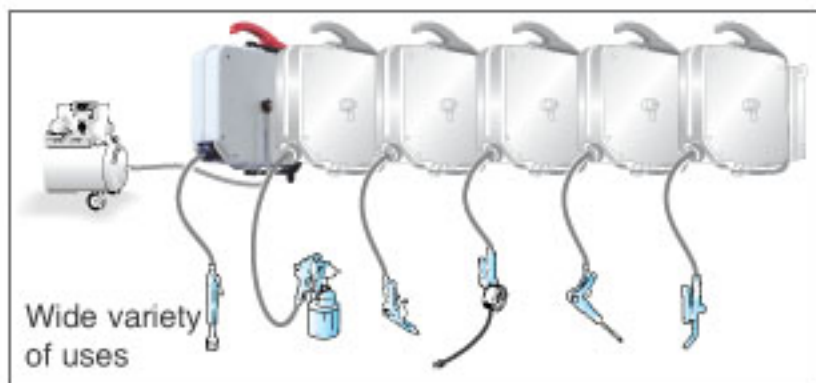
Wide variety
of uses

Overall dimensions

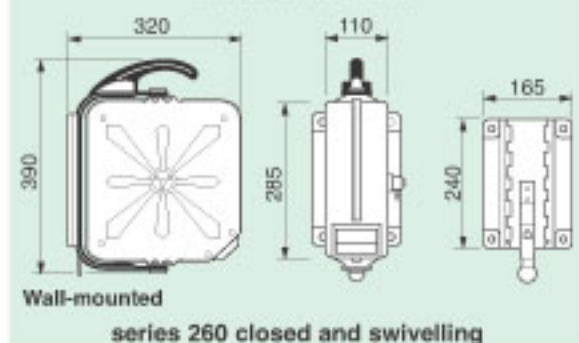

Wall-mounted

series 260 closed and swivelling



Every hose-reel is provided with a wall bracket (art. 89001) facilitating wall mounting. This bracket is equipped with bayonet hooking enabling quick connection and disconnection of hose-reel thus enabling it to be shifted to various workpoints, after applying more brackets.

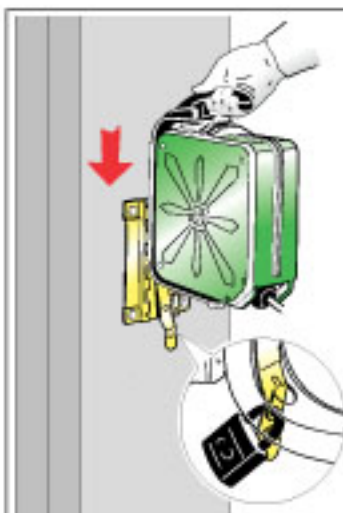

To prevent removal or theft of hose-reel it can be locked with a bolt or lock.

QUICK HOOKING OF HOSE-REEL

Bayonet bracket art.89001 easy wall-mounting



Easy to carry handle

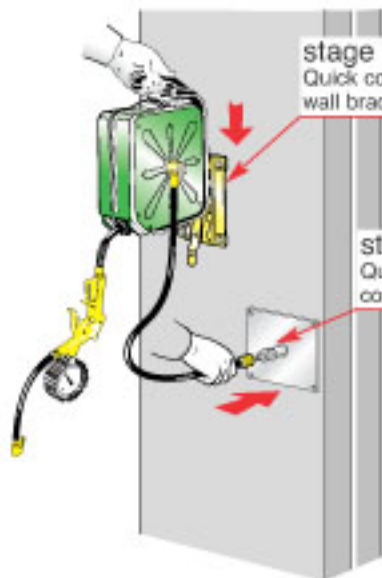
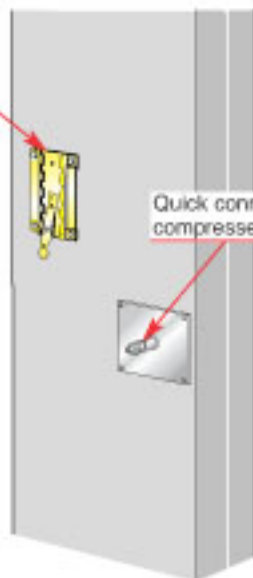

stage 1 Quick connection of hose-reel to wall bracket

stage 2 Quick connection to compressed-air system

QUICK RELEASE OF HOSE-REEL

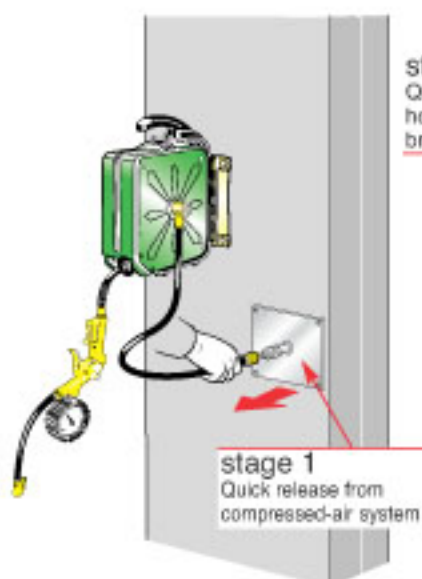

stage 1 Quick release from compressed-air system

stage 2 Quick release of hose-reel from wall bracket

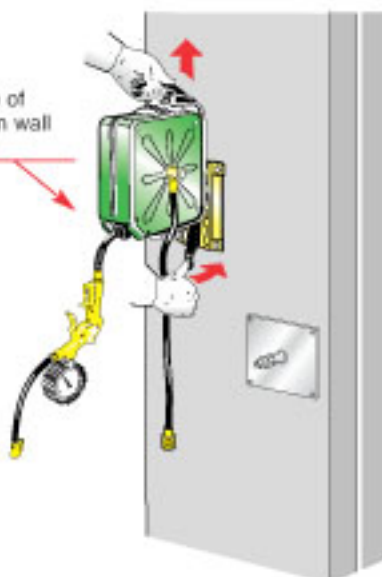

Easy to carry handle reduced weight



