



# Stenhøj Maestro 2.50

## 2-post electro-mechanical lift

Maestro 2.50 is suitable for all kinds of repairs. The lift is without base frame, making it especially suitable for repairs that require auxiliary equipment. Maestro 2.50 has a lifting capacity of 5 t.

### Features:

Top safety

- nut breakage system
- obstruction system
- automatic arm lock system
- electronic synchronization system

Elegant control box

- with dead-man controls and separate main switch

Double telescopic arms

- min./max. range of arms 875/1960 mm
- lifts all small, medium-sized and large types of passenger cars and vans

Slim, symmetric construction

- easy access - allows lifting of very long vehicles

Lifting height

- 2065 mm

### Maestro 2.50

- is like all other Stenhøj lifts CE-approved



## STENHØJ

DK-7150 Barrit

Phone: +45 7682 1330

Fax: +45 7682 1331

[www.stenhøj.dk](http://www.stenhøj.dk)

E-mail: [autolift@stenhøj.dk](mailto:autolift@stenhøj.dk)

# Stenhøj Maestro 2.50

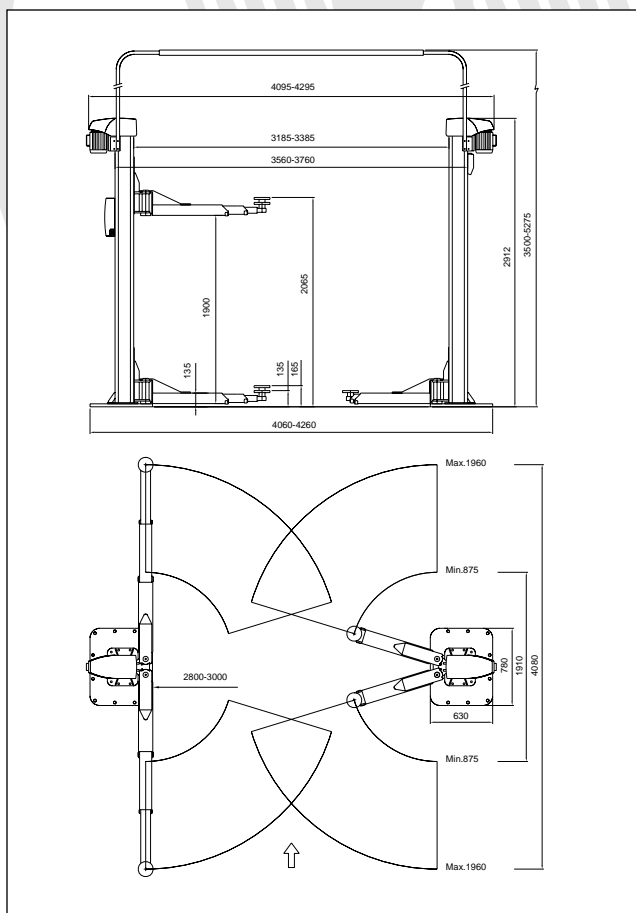

**Technical data:** **Maestro 2.50**  
 Lifting capacity: 5000 kg  
 Lifting time: 55 sec.  
 Motor: 2 x 2.8 kW

#### Optional extras:

Expansion bolts, a large program of U- and flex pads.

#### Corrosion-proof surface treatment

All Stenhøj lifts are led through a sling purifying plant (according to SA2.50 - ISO-Norm 8501-1:1988), dipped in primer, and finally led through an electro-static powder bake plant.

#### Standard colours:

Red RAL 3013  
 White RAL 9002  
 Special colour combinations on request.

No liability accepted for specification, which are subject to alteration.



Maestro 2.50 is delivered as standard with 135-165 mm flex pads. We offer as optional extras a large program of U- and flex pads; fixed as well as adjustable.



## STENHØJ

DK-7150 Barrit  
 Phone: +45 7682 1330  
 Fax: +45 7682 1331  
[www.stenhøj.dk](http://www.stenhøj.dk)  
 E-mail: [autolift@stenhoj.dk](mailto:autolift@stenhoj.dk)